

IntElect Model 110

Demag Plastics Group		IntElect Model 110		
Model Description		IntElect Model 110		
International Size Description		150	310	410

Clamp Unit				
Clamp Force	U.S. tons kN	110	1000	
Clamp Stroke - Max.	in. mm	15.0	380	
Open Daylight - Max.	in. mm	31.9	810	
Mold Thickness - Min.	in. mm	7.9	200	
Mold Thickness - Max.	in. mm	16.9	430	
Distance Between Tie Bars				
Horizontal	in. mm	16.5	420	
Vertical	in. mm	16.5	420	
Platen Size				
Horizontal (Standard)	in. mm	23.6	600	
Vertical	in. mm	23.6	600	
Tie Bar Diameter	in. mm	2.56	65	
Ejector Data				
Ejector Stroke	in. mm	3.9	100	
Ejector Force	U.S. tons kN	3.9	35	

Injection Unit		150			310			410		
	Measure	A	B	C	A	B	C	A	B	C
Injection Capacity (GPPS)	oz.	1.6	2.3	3.1	3.6	4.9	6.4	5.2	6.8	8.7
	g	45	66	89	101	138	181	148	194	246
Injection Capacity	cu. in.	3.1	4.5	6.2	7.0	9.5	12.4	10.2	13.4	17.0
	ccm	51	74	101	114	155	203	168	219	278
Recovery Rate (GPPS)	oz./sec.	0.4	0.6	0.9	0.6	0.9	1.3	0.9	1.3	1.8
	g/sec	10.1	17.8	26.1	17.8	26.1	37.2	26.1	37.2	50.1
Injection Pressure	psi	40,600	29,300	21,500	36,300	31,200	23,800	33,900	27,100	21,300
	bar	2,800	2,020	1,485	2,500	2,150	1,640	2,340	1,865	1,470
Injection Rate	cu. in./sec.	4.5	6.4	8.8	6.4	8.8	11.5	8.8	11.5	14.5
	ccm/sec	73	105	144	105	144	188	144	188	238
Injection Stroke	in.	4.1	4.1	4.1	6.4	6.4	6.4	6.9	6.9	6.9
	mm	105	105	105	162	162	162	175	175	175
Screw Diameter	in.	0.98	1.18	1.38	1.18	1.38	1.57	1.38	1.57	1.77
	mm	25	30	35	30	35	40	35	40	45
Screw L/D Ratio		20/1	20/1	20/1	20/1	20/1	20/1	20/1	20/1	20/1
Maximum Screw Speed	rpm	500	500	500	500	500	500	500	500	500
Back Pressure Adjust	psi	50-300	50-300	50-300	50-300	50-300	50-300	50-300	50-300	50-300
	bar	3.5-20.7	3.5-20.7	3.5-20.7	3.5-20.7	3.5-20.7	3.5-20.7	3.5-20.7	3.5-20.7	3.5-20.7
Barrel Heating Capacity	kW	5.7	8.3	9.4	8.3	9.4	11.1	9.4	11.1	11.3

General Machine Specifications		150			310			410		
	Measure									
Length	ft. m	15.3	4.67		15.3	4.67		15.3	4.67	
Width	ft. m	4.4	1.34		4.4	1.34		4.4	1.34	
Height	ft. m	6.3	1.93		6.3	1.93		6.3	1.93	
Machine Weight (approx.)	lb. kg	11,000	5,000		11,000	5,000		11,000	5,000	

Performance specifications are based on theoretical data and mold, material and conditions. Since continuous improvement is Demag Plastics Group's policy, we reserve the right to change specifications, designs and performance data without prior notice or obligation.

The specifications listed are standard. However, Demag Plastics Group will provide engineered options and solutions to meet virtually any performance requirements.

IntElect Model 110

CLAMP ASSEMBLY

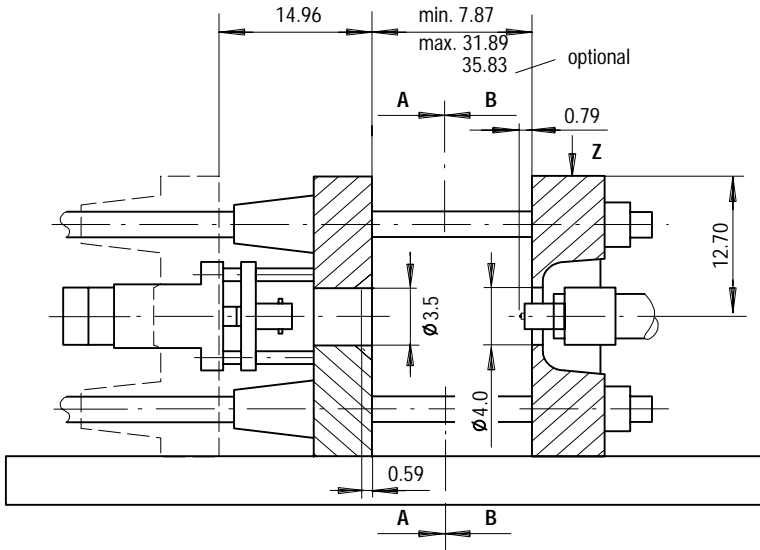

ROBOT MOUNTING PATTERN

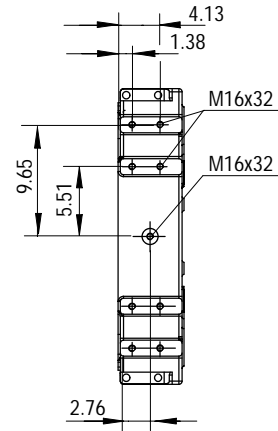

STATIONARY PLATEN

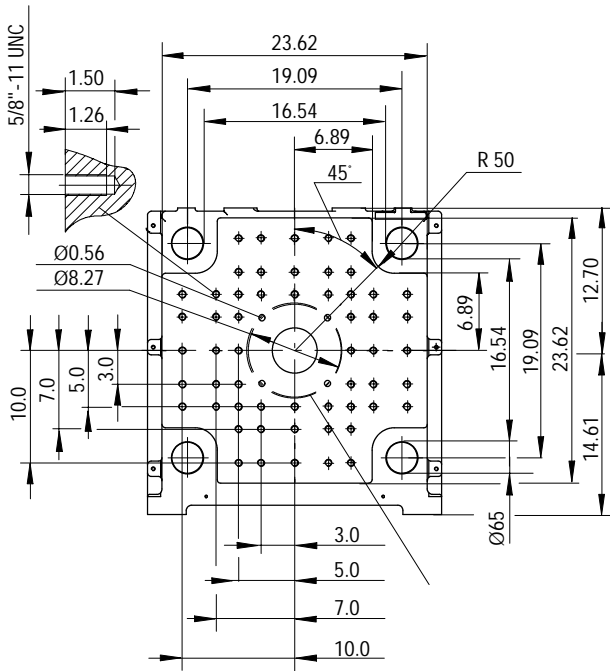

MOVABLE PLATEN

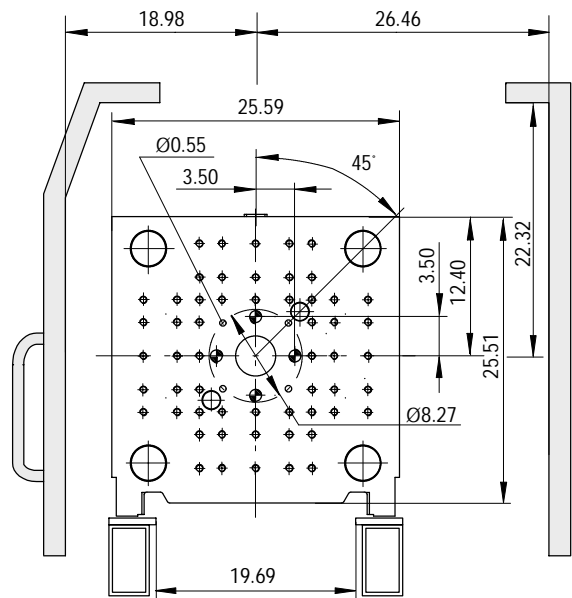

Min. mold – 8.46" x 8.46" (215 mm x 215 mm)
 Max. mold weight – 1,555 lbs. (700 kg)
 Max. mold weight on movable platen – 1,000 lbs. (450 kg)

☉ Bore $\phi 1.06$ " (27 mm) through holes

1) Bore $\phi 0.55$ " (14 mm) through holes and $\phi 0.79$ " (20 mm) from opposite side