

VAN DORN®

700 HP SERIES

Injection Unit

International Size	Measure	2800		4300		6800	
		Std.	HiPr	Std.	HiPr	Std.	HiPr
Injection Capacity (GPPS)	oz. g	59 1,678	45 1,284	90 2,540	64 1,800	139 3,943	104 2,940
Injection Capacity	cu. in. ccm	108.6 1,780	83.1 1,362	164.4 2,694	116.6 1,911	255.2 4,182	190.3 3,118
Recovery Rate (GPPS)	oz./sec. g/sec	3.04 86	2.25 64	3.76 107	3.04 86	4.42 125	3.76 107
Injection Pressure	psi bar	22,949 1,582	29,974 2,067	23,435 1,616	33,047 2,279	23,791 1,640	31,898 2,199
Injection Rate (@ 10,000 psi) (@ 700 bar)	cu. in./sec. ccm/sec	61.4 1,006	47.0 770	60.1 985	42.6 698	59.2 970	44.2 724
Injection Stroke	in. mm	13.94 354	13.94 354	14.96 380	14.96 380	17.32 440	17.32 440
Screw Diameter	in. mm	3.15 80	2.76 70	3.74 95	3.15 80	4.33 110	3.74 95
Screw L/D Ratio		20/1 20/1	20/1 20/1	20/1 20/1	20/1 20/1	20/1 20/1	20/1 20/1
Maximum Screw Speed	rpm rpm	179 179	204 204	151 151	179 179	130 130	151 151
Back Pressure Adjust	psi bar	75-300 5-21	75-300 5-21	75-300 5-21	75-300 5-21	75-300 5-21	75-300 5-21
Barrel Heating Capacity	kW kW	38 38	34 34	56 56	43 43	63 63	54 54

General Machine Specifications

	Measure	2800	4300	6800
Pump Motor	hp kW	125 93	125 93	125 93
Pump Capacity	gpm lpm	193 731	193 731	193 731
Oil Capacity	gal. l	540 2,045	540 2,045	540 2,045
Machine Weight (approx.)	lb. kg	80,500 36,510	81,500 36,970	84,500 38,330
Machine Dimensions				
Length	ft. m	32.4 9.9	34.5 10.5	36.3 11.1
Width	ft. m	7.4 2.3	7.4 2.3	7.4 2.3
Height	ft. m	10.0 3.0	10.0 3.0	10.0 3.0

Performance specifications are based on theoretical data and mold, material and conditions. Since continuous improvement is Van Dorn Demag's policy, we reserve the right to change specifications, designs and performance data without prior notice or obligation.

Clamp Unit

Clamp Force	U.S. tons kN	700 6,227
Open Force	U.S. tons kN	31 276
Clamp Stroke - Max.	in. mm	44 1,118
Open Daylight - Max. (w/o Ejector Box)	in. mm	72.75 1,848
Mold Thickness - Min. (w/ Ejector Box)	in. mm	16 406
Ejector Box Thickness	in. mm	12.75 324
Distance Between Tie Bars		
Horizontal (Standard)	in. mm	36.5 927
(Optional Extended Tie Bar Spacing)	in. mm	445 1,143
Vertical	in. mm	36.5 927
Platen Size		
Horizontal (Standard)	in. mm	53.5 1,359
(Optional Extended Tie Bar Spacing)	in. mm	62 1,575
Vertical	in. mm	53.5 1,359
Tie Bar Diameter	in. mm	6.5 165
Clamp Speeds		
Closing	in./sec. mm/sec.	29 737
Opening	in./sec. mm/sec.	25 635
Ejector Force	U.S. tons kN	12.5 111
Ejector Stroke	in. mm	6 152

Extended tie bar spacing reduces minimum mold thickness and maximum open daylight by 1½".

The specifications listed are standard. However, Van Dorn Demag will provide engineered options and solutions to meet virtually any performance requirements including high-pressure and high-speed configurations.

VAN DORN®

700 HP SERIES

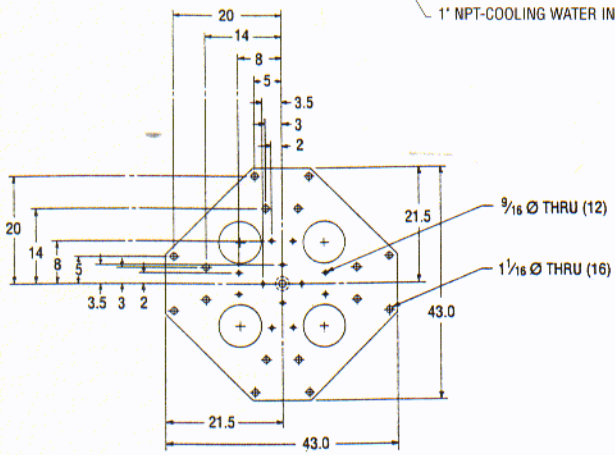
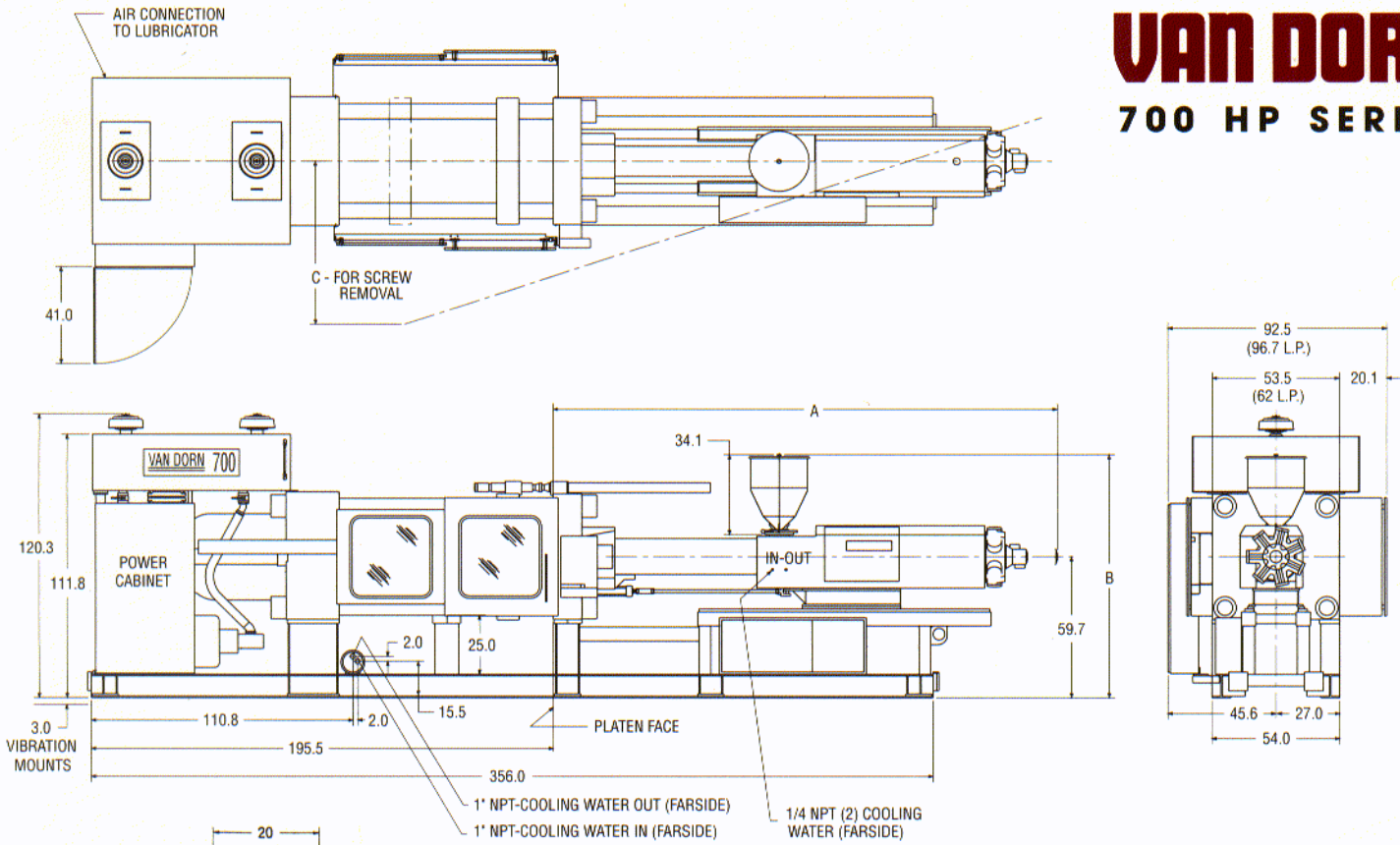

EJECTOR PLATE

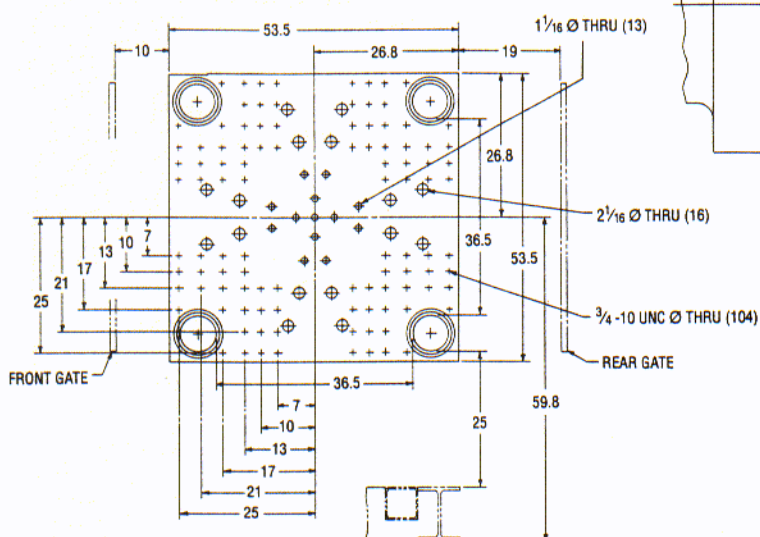

MOVABLE PLATEN

Injection Unit	A	B	C
STANDARD BARREL			
80mm / 2800	193.0	102.0	62.0
95mm / 4300	218.0	103.0	69.0
110mm / 6800	240.0	104.0	70.0

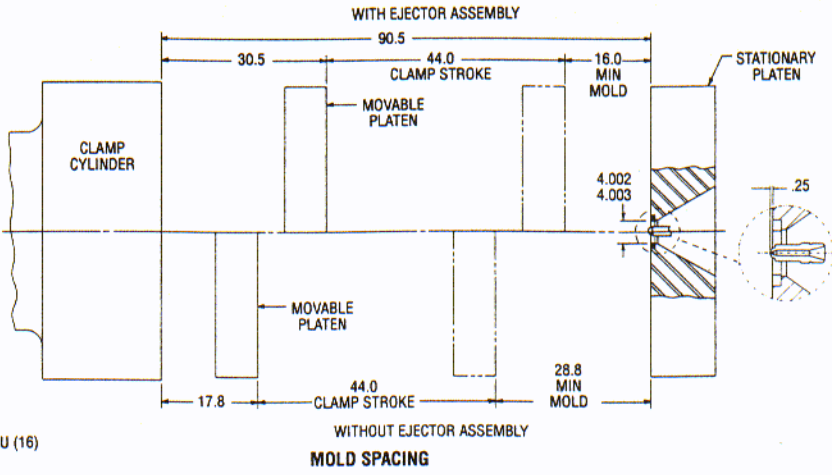

VAN DORN DEMAG®

Van Dorn Demag Corporation
 11792 Alameda Drive
 Strongsville, Ohio 44136
 Telephone (440) 876-8960
 FAX (440) 876-4383
 Web: www.vandorn.com